

Flexi-Q eMU-C

Electromechanical Multi-use Auto-injector for drugs in cartridges



Pharmaceutical Company Advantages:

- Compatible with standard 3 ml / 1.5 ml cartridge.
- Suitable for injection of high viscosity drugs.
- Enables injection of dosages as low as 0.005 ml with high accuracy.
- Allows reconstitution using dual chamber cartridge.
- Drug recognition and safety improvement, using RFID technology.



Patient Benefits:

- Advanced user interface - Step by step instructions on device screen.
- Injections data recording and logs.
- Wireless communication to a remote data base.
- Calendar reminders.
- Injection time control - can be adjusted to reduce pain.
- Enables automatic priming.

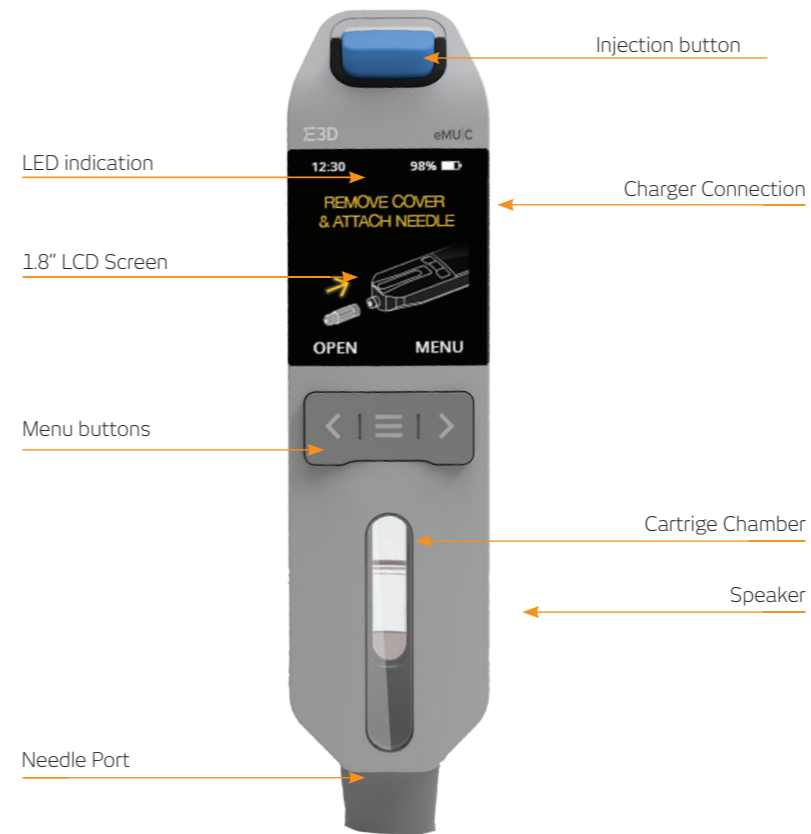

Flexi-Q eMU-C system is comprised of a reusable Device and single-use Cassette, pre-loaded with a standard pre-filled cartridge.

Flexi-Q eMU-C is intended for use in chronic diseases that require frequent injections (e.g. multiple sclerosis, diabetes and others) and is configurable for both fixed and variable dose volumes. The reusable design of Flexi-Q eMU-C lowers the cost per injection and reduces the volume of material for storage and disposal.

User steps



1. Insert Cassette into Device port



2. Remove Safety Cap Attach needle



3. Push Device against injection site and press Inject button



Prime (once for each new cartridge)



4. Eject Cassette Detach needle and dispose of in appropriate container.