



OBI-1 Wearable Injector

Datasheet

Bolus wearable Injector for subcutaneous administration of drugs

Technical Data	
Device Specifications	
Supply configuration	Blister packed
Primary container format	PFS 1 mL
Primary container fill volume	Up to 1mL
Dosing	Fixed; deliver container contents.
Target Tissue	Subcutaneous

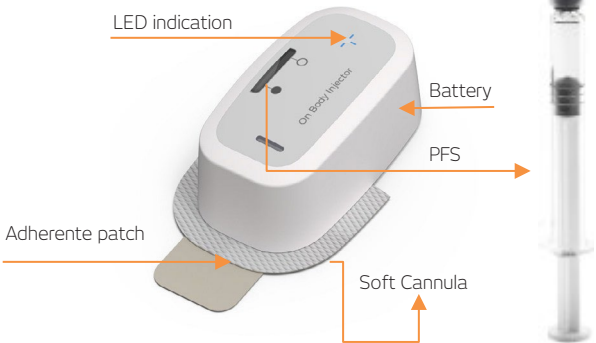

User Step

1



Fill the reservoir from the pre-filled syringe (PFS)

2



Peel back adhesive tab

3



Remove the filling port to un-sheath the insertion needle and cannula.

4



The healthcare professional places OBI-1 on the patient's tissue. The device inserts the needle and soft cannula, and the injection starts automatically as programmed.

Key Features



Fully automatic
injection process



Advance user
interfase



Outpatiente
care

Medical & Dosing	
Viscosity	Up to 15cP
Injection duration	Tailored according to drug and therapy
User feedback	Audible and visual signals
Administration	
Injection element	Soft Cannula
Needle safety system	Automated; passive
Driving mechanism	Pneumatic Pressure
System control	Pre-programmed injection parameters according to drug and therapy
Device Variant Options	
Wireless Connectivity	Yes